

# GUARANTEED STERILITY READY WHEN YOU ARE



Ambu® aScope™ 4 Broncho

**Ambu**

# THE SINGLE-USE BRONCHOSCOPE SOLUTION YOU CAN TRUST

Ambu has the experience, setup and focus it takes to deliver the single-use solution you need

## The world's largest supplier of single-use endoscopes

Since launching the first aScope in 2009, Ambu aScope technology has been used in over 1.5 million bronchoscopies and intubations worldwide, and 87% of doctors who evaluated Ambu® aScope™ 4 Broncho in their ICU stated that it could replace their current reusable scope¹.

## Dedicated to single-use endoscopy

We currently have 100 in-house and 160 strategic-partner engineers working exclusively on single-use endoscopes to make sure you always have the most innovative solutions at your disposal.

## Count on quality solutions delivered

Ambu R&D works closely with medical specialists and personnel at our own advanced production facilities to deliver high quality efficiently. Because we have an agile infrastructure, we are ready to scale up and deliver innovative new products fast - ensuring that you will not be left empty-handed.



## THE Ambu SINGLE-USE ENDOSCOPE PORTFOLIO:

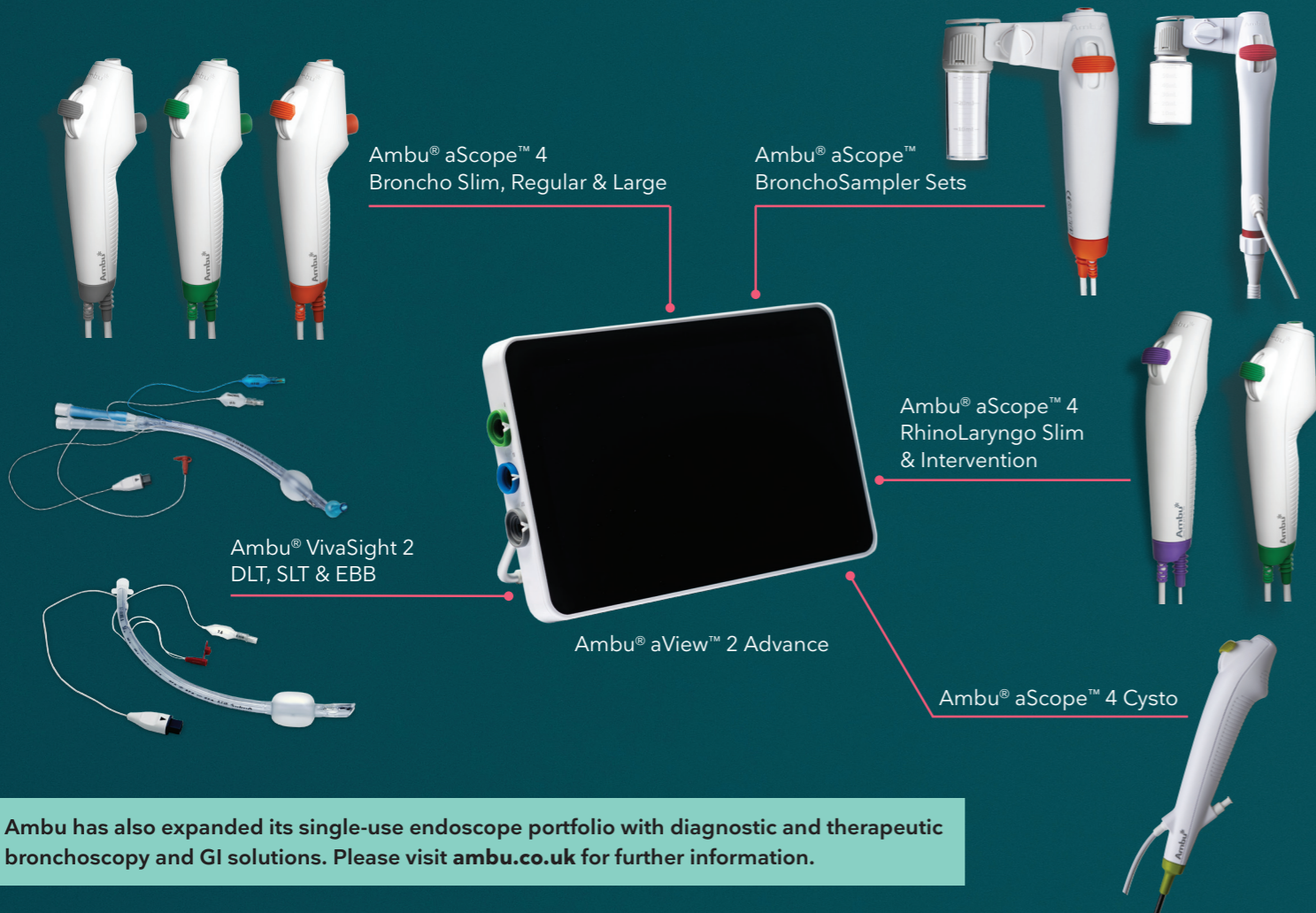

## A READY-TO-GO SINGLE-USE FLEXIBLE BRONCHOSCOPY SOLUTION

The aScope 4 Broncho endoscopes are part of a ready-to-go single-use flexible bronchoscopy solution that can be used for a wide array of procedures all over the hospital from intubations and thoracic anaesthesia in the OR to routine bronchoscopy in the ICU. The bronchoscopes are guaranteed sterile, always available and part of an integrated solution that improves safety, workflow and productivity.

**Guaranteed sterility**  
- Straight from the pack

**Ready when you are**  
- A brand new bronchoscope is always available whenever you need it

**Hassle-free bronchoscopy solution**  
- Integrated with Ambu® BronchoSampler™ and the Ambu® aView™ 2 Advance monitor, a high-quality, portable full HD monitor



Clinical image from ex vivo porcine lung.

Ambu has also expanded its single-use endoscope portfolio with diagnostic and therapeutic bronchoscopy and GI solutions. Please visit [ambu.co.uk](http://ambu.co.uk) for further information.

# GUARANTEED STERILITY

## Bronchoscopes are meant to save lives

Today, over 2.4 million routine bronchoscopies and intubations are performed yearly in ICUs and ORs around the world to treat patients in an effective and relatively non-invasive manner.

However, there is growing concern that even with the most stringent high-level disinfection procedures, sterility cannot be assured. This potentially puts your patients at risk.

## Are your patients at risk?

Studies have found that 8% of reusable bronchoscopes are contaminated<sup>4</sup>, and 20%<sup>5</sup> of those bronchoscopes lead to cross-infection.

## An extra measure of safety

With the aScope 4 Broncho solution, you get a brand-new, sterile bronchoscope straight from the pack every time.



“Most contemporary flexible endoscopes cannot be heat sterilised and are designed with multiple channels, which are difficult to clean and disinfect<sup>2</sup>

“Routine cleaning does not effectively remove biofilm from endoscope channels<sup>3</sup>



## A typical story from the real world:

For an intensivist like me, setting up a bronchoscopy can be a cumbersome process. This is how it generally goes:

First, I call the respiratory therapist (RT). Then, I wait for them to call back - often for more than 5 to 10 minutes or longer - and once I ask for the bronchoscopy there's an awkward pause...

“When do you need it... can it wait?”

“NO! I need it now!”

“Well, can it wait 15 to 20 minutes?”

Considerable time has already been lost.

Even if it's not super urgent, it can still be difficult to manage. For example, I call when I've seen a patient in the morning and know I'm going to need a good sample because I suspect pneumonia.

I ask the RT if they can save a spot in their schedule sometime after lunch, but - because it's not an emergency - I'm the one who has to be flexible and reprioritise my time.

# READY WHEN YOU ARE

## When planning gets in the way...

The aScope 4 Broncho is ready when you are, reducing the risks and frustrations associated with waiting for an available endoscope. aScope 4 Broncho can be stored directly in the units, so you simply grab the scope and monitor and are ready to go. If you know you will be taking a fluid sample, pick up the aScope BronchoSampler with the accessories you need to perform the procedure.

## ...It's nice to know that a bronchoscope is always available

The aScope 4 Broncho single-use bronchoscopy solution is portable, easy to set up and intuitive to use saving you valuable time. Because the endoscopes are single-use, you always have a bronchoscope available when you need it. So you can focus less on planning and more on what matters most: your patients.

<sup>1</sup>JA Livesey and MJG Dunn 2018 "Prospective non-interventional evaluation of intubation and intensive care use of the new Ambu aScope 4 Broncho and aView 2 Advance"

<sup>2</sup><sup>5</sup>Kovaleva J, Peters FT, van der Mei HC, Degener JE. "Transmission of infection by flexible gastrointestinal endoscopy and bronchoscopy". Clin Microbial Rev. 2013 Apr;26(2):231-54. Doi: 10.1128/CMR.00085-12

<sup>3</sup>Pajkos et al. "Is biofilm accumulation on endoscope tubing a contributor to the failure of cleaning and contamination?" Journal of Hospital Infection, 2004, 58:224-229

<sup>4</sup>Internal data on file

# YOUR HASSLE-FREE BRONCHOSCOPY SOLUTION

The aScope 4 Broncho is more than a just a bronchoscope. It is an integrated solution, that helps you deliver the very best in patient care.

## Clearly visualise the bronchial segments

- Easily connects to the high-quality, full-HD portable Ambu® aView™ 2 Advance monitor

## Easy to handle throughout a long day of multiple procedures

- Lightweight, ergonomic design with high-bending angles and a smooth and precise tip motion

## Use in a wide variety of procedures

- Includes three sizes for multiple procedures and the aScope BronchoSampler, a tailor-made solution that helps simplify the sampling process



## THE Ambu® aView™ 2 ADVANCE: A FULL-HD PORTABLE MONITOR

aView 2 Advance is a high-quality, portable full-HD monitor for single-use endoscopy, designed to help you work confidently and keep the focus on your patients.

### Full-HD resolution (1920 x 1080) offers excellent imaging

Advanced image processing with adaptive light control on a 12.8-inch anti-reflective touchscreen ensures continuous optimisation of the image quality.

### Flexible and intuitive

The aView 2 Advance monitor is easy to manoeuvre into a comfortable working position close to you and the patient. The monitor fits into small spaces and can be rotated 180-degrees, allowing you to connect it in the best position for that specific clinical situation; the graphical user interface will adapt automatically.

### Stay connected

You can easily transfer your recorded patient imaging data to the PACS to enable access from the EHR system. If you need a larger image, you can connect to high-quality external monitors (via HDMI or 3G-SDI outputs).

This forward thinking design enables you to upgrade and take advantage of the latest imaging capabilities, advanced features and future Ambu endoscope releases. Repair options are available to help extend the lifetime of your investment, if an unexpected problem should occur.



**aScope 4 Broncho**  
Slim 3.8/1.2  
180°/180°

**aScope 4 Broncho**  
Regular 5.0/2.2  
180°/180°

**aScope 4 Broncho**  
Large 5.8/2.8  
180°/160°

**aScope BronchoSampler**

### **aScope 4 Broncho flexible single-use bronchoscope**

<b>Item code</b>	<b>Product</b>
476 001 000	aScope 4 Broncho Slim 3.8/1.2
477 001 000	aScope 4 Broncho Regular 5.0/2.2
478 001 000	aScope 4 Broncho Large 5.8/2.8

### **aScope 4 Broncho flexible single-use bronchoscope**

<b>Item code</b>	<b>Product</b>
405 011 000	aView 2 Advance monitor

### **aScope 4 Broncho Sampler**

<b>Item code</b>	<b>Product</b>
477 501 000	aScope 4 Broncho Regular 5.0/2.2 Sampler Set
478 501 000	aScope 4 Broncho Large 5.8/2.8 Sampler Set
480 500 000	aScope Broncho Sampler 60ml sample containers

Marcom ID: 9617 - 2019/10 - Ambu A/S. Technical data may be modified without further notice.

## **A HISTORY OF BREAKTHROUGH IDEAS**

Ambu has been bringing the solutions of the future to life since 1937. Today, millions of patients and healthcare professionals worldwide depend on the efficiency, safety and performance of our single-use endoscopy, anaesthesia, and patient monitoring & diagnostics solutions.

The manifestations of our efforts have ranged from early innovations like the Ambu® Bag™ resuscitator and the Ambu® BlueSensor™ electrodes to our newest landmark solutions like the Ambu® aScope™ - the world's first single-use flexible endoscope. Moreover, we continuously look to the future with a commitment to deliver innovative quality products that have a positive impact on your work.

Headquartered near Copenhagen in Denmark, Ambu employs approximately 3,000 people in Europe, North America and the Asia Pacific.

For more information, please visit [ambu.co.uk](http://ambu.co.uk)



Ambu Limited  
Incubator 2  
Alconbury Weald Enterprise Campus  
Alconbury Weald  
Cambridgeshire  
PE28 4XA  
T: 01480 498403  
[ambu.co.uk](http://ambu.co.uk)